

ACTION

IMPACT SOCKETS FOR SCREWDRIVERS



1/4" Drive

6-Point

1

Type	A/F mm	Drawing	D1 mm	L mm	L1 mm
Metric					
DO697B0S04	4	A	8	55	4,5
DO697B0S06	6	A	10	55	4,5
DO697B0T06	6	A	10	75	4,5
DO697B0T07	7	A	11	75	4,5
DO697B0T08	8	A	12	75	4,5
DO697B0T10	10	A	14	75	5,5
DO697B0T12	12	A	17	75	5,5
DO697B0T13	13	A	18	75	5,5
DO697B0T14	14	A	19	75	5,5
DO697B0W12	12	A	17	200	5,5
DO697B0W14	14	A	19	200	5,5

6-Point deep magnetic

2

Type	A mm	Drawing	D1 mm	L mm	L1 mm
Metric					
DO697B6006	6	C	10	75	4,5
DO697B7006	6	C	10	100	4,5
DO697B7008	8	C	12	100	4,5
DO697B7010	10	C	14	100	5,5
DO697B7012	12	C	17	100	5,5
DO697B7013	13	C	18	100	5,5
DO697B7014	14	C	19	100	5,5
DO697B8006	6	C	10	150	4,5
DO697B8008	8	C	12	150	4,5
DO697B8010	10	C	14	150	5,5
DO697B8012	12	C	17	150	5,5
DO697B8013	13	C	18	150	5,5
DO697B8014	14	C	19	150	5,5
DO697B9006	6	C	10	200	4,5
DO697B9008	8	C	12	200	4,5
DO697B9010	10	C	14	200	5,5
DO697B9012	12	C	17	200	5,5
DO697B9013	13	C	18	200	5,5
DO697B9014	14	C	19	200	5,5

6-Point magnetic

2

Type	A/F mm	Drawing	D1 mm	L mm	L1 mm
Metric					
DO697B0M06	6	B	10	55	4,5
DO697B0M07	7	B	11	55	4,5
DO697B0M08	8	B	12	55	4,5
DO697B0M10	10	B	14	55	5,5
DO697B0M11	11	B	16	55	5,5
DO697B0M12	12	B	17	55	5,5
DO697B0M13	13	B	18	55	5,5
DO697B0M14	14	B	19	55	5,5
DO697B0N10	10	B	14	75	5,5
DO697B0N12	12	B	17	75	5,5
DO697B0P06	6	B	10	100	4,5
DO697B0P07	7	B	11	100	4,5
DO697B0P08	8	B	12	100	4,5
DO697B0P10	10	B	14	100	5,5
DO697B0P12	12	B	17	100	5,5
DO697B0P13	13	B	18	100	5,5
DO697B0P14	14	B	19	100	5,5
DO697B0P17	17	B	23	100	5,5
DO697B0Q10	10	B	14	150	5,5
DO697B0R10	10	B	14	200	5,5

Tap holding sockets

3

Type	A mm	Drawing	Ø d mm	Ø D mm	L mm
Metric					
DO63A65001	3,4	D	4,5	14	55
DO63A65002	4,9	D	6,0	15	55
DO63A65003	5,5	D	7,0	16	55
DO63A65004	6,2	D	8,0	17	60
DO63A65005	7,0	D	9,0	18	70
DO63A65006	8,0	D	10,0	19	70
DO63A65007	9,0	D	11,0	20	70
DO63A65008	9,0	D	12,0	21	70
DO63A65009	11,0	D	14,0	23	75

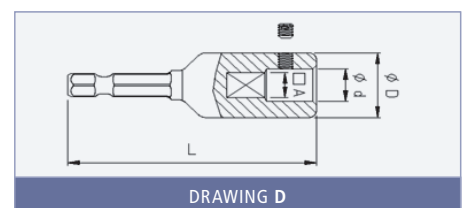

DRAWING D

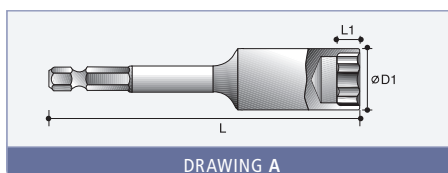

DRAWING A

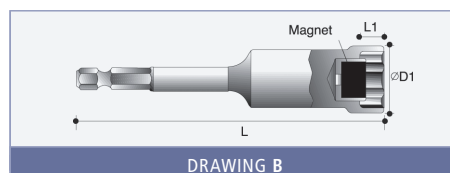

DRAWING B

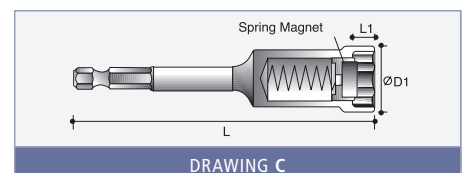

DRAWING C