



# ACTION

## IMPACT SOCKETS



### 3/4" Drive

6-Point normal  3						Deep  4			
Type	A/F mm	DRAWING	D1 mm	D2 mm	L mm	L2 mm	Type	L mm	L2 mm
<b>Metric</b>									
DO3034-0-013	13	A	25	44	50	9	DO3034-1-013	95	13
DO3034-0-017	17	A	31	44	50	12	DO3034-1-017	95	17
DO3034-0-018	18	A	32	44	50	13	DO3034-1-018	95	18
DO3034-0-019	19	A	33	44	50	13	DO3034-1-019	95	19
DO3034-0-021	21	A	36	44	50	15	DO3034-1-021	95	21
DO3034-0-022	22	A	37	44	50	15	DO3034-1-022	95	22
DO3034-0-024	24	A	40	44	50	16	DO3034-1-024	95	24
DO3034-0-027	27	A	43	44	54	16	DO3034-1-027	95	27
DO3034-0-030	30	C	47	44	54	21	DO3034-1-030	95	30
DO3034-0-032	32	C	49	44	56	21	DO3034-1-032	95	32
DO3034-0-033	33	C	51	44	56	22	DO3034-1-033	95	33
DO3034-0-036	36	C	54	44	56	22	DO3034-1-036	95	36
DO3034-0-038	38	C	57	44	58	24	DO3034-1-038	95	38
DO3034-0-041	41	C	61	44	58	24	DO3034-1-041	95	38
DO3034-0-046	46	C	67	44	63	27	DO3034-1-046	95	38
DO3034-0-050	50	C	71	54	72	32	DO3034-1-050	95	38
DO3034-0-055	55	C	77	54	74	35	DO3034-1-055	95	40
DO3034-0-060	60	C	84	54	75	35	DO3034-1-060	95	42

Hex driver (inbus)  5						
Type	A/F mm	Drawing	D2 mm	L mm	L1 mm	-
<b>Metric</b>						
DO696510A	10	D	44	100	20	-
DO696512A	12	D	44	100	20	-
DO696514A	14	D	44	100	20	-
DO696517A	17	D	44	100	20	-
DO696519A	19	D	44	100	20	-
DO696522A	22	D	44	100	20	-
DO696524A	24	D	44	100	20	-
DO696527A	27	D	44	100	20	-

Torx® internal  6						
Type	A/F mm	Drawing	D2 mm	L mm	L1 mm	-
DO64742050	T50	F	44	100	5,0	-
DO64742055	T55	F	44	100	5,5	-
DO64742060	T60	F	44	100	8,0	-
DO64742070	T70	F	44	100	9,4	-
DO64742080	T80	F	44	100	10,5	-
DO64742090	T90	F	44	100	11,8	-
DO64742100	T100	F	44	100	13,1	-

Torx® is a trademark of Textron.

## IMPACT SOCKETS



### 3/4" Drive

#### Torx® external



1

Type	A/F mm	Drawing	D1 mm	D2 mm	L mm	L1 mm
D063340018	E18	A	25	44	56	12
D063340020	E20	A	27	44	56	15
D063340022	E22	A	30	44	56	15
D063340024	E24	A	33	44	56	16
D063340032	E32	A	44	44	56	24

Torx® is a trademark of Textron.

#### 12-Point normal



1

#### Deep



2

Type	A/F mm	DRAWING	D1 mm	D2 mm	L mm	L2 mm	Type	L mm	L2 mm
------	--------	---------	-------	-------	------	-------	------	------	-------

#### Metric

D063845013	13	A	23	38	50	9	D065847013	95	13
D063845016	16	A	27	38	50	11	D065847016	95	16
D063845017	17	A	28	38	50	12	D065847017	95	17
D063845018	18	A	29	38	50	13	D065847018	95	18
D063845019	19	A	30	38	50	13	D065847019	95	19
D063845020	20	A	31	38	52	14	D065847020	95	20
D063845021	21	A	32	38	52	15	D065847021	95	21
D063845022	22	A	34	38	52	15	D065847022	95	22
D063845024	24	A	36	38	52	18	D065847024	95	24
D063845026	26	C	40	38	52	18	D065847026	95	26
D063845027	27	C	40	38	52	19	D065847027	95	27
D063845028	28	C	42	38	52	19	D065847028	95	28
D063845029	29	C	43	38	52	21	D065847029	95	29
D063845030	30	C	43	38	52	21	D065847030	95	30
D063845031	31	C	44	38	56	21	D065847031	95	31
D063845032	32	C	45	38	56	22	D065847032	95	32
D063845033	33	C	46	38	56	22	D065847033	95	33
D063845034	34	C	48	38	56	22	D065847034	95	34
D063845035	35	C	50	38	56	22	D065847035	95	35
D063845036	36	C	51	38	56	25	D065847036	95	36
D063845037	37	C	52	38	56	25	D065847037	95	37
D063845039	39	C	55	38	62	25	D065847039	95	38
D063845041	41	C	58	38	62	27	D065847041	95	38
D063845042	42	C	61	38	62	27	D065847042	95	38
D063845043	43	C	63	38	62	27	D065847043	95	38
D063845046	46	C	67	38	68	30	D065847046	100	38
D063845050	50	C	71	38	70	32	D065847050	100	38
D063845055	55	C	77	54	74	35	D065847055	105	40
D063845056	56	C	77	54	74	35	D065847056	105	40

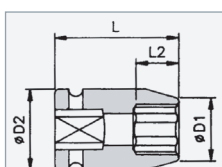

DRAWING A

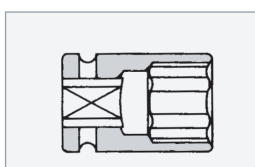

DRAWING B

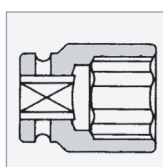

DRAWING C