

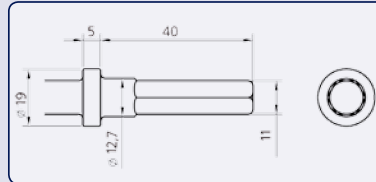

HAMMER RRH-2000

Features:

- Designed and developed for renovation work, the RRH-2000 is a new hammer to the Red Rooster programme.
- The hammer has a very high energy blow per minute but has the advantage of very low weight.
- An ergonomically designed grip enables both right and left handed use without compromising on comfort.
- Supplied as standard the hammer is delivered with an open retaining spring to enable the use of both pointed and broad blade chisels.



FOR HAMMER
- RRH-2000

Shank size 11 mm 6KT / Ø12,7 mm x 40 mm

Ordernumber	Description	L (mm) total	B (mm)
CB51109165	Flat Chisel	165	18
CB51112180	Wide flat chisel	180	33
CB51104190	Wide flat chisel, bent	190	33
CB51103185	Wide flat chisel	185	45
CB51115180	Moil point	180	-
CB51193180	Slotting tool with carbide tip	180	38

Type	Brand	Shank-size mm	Bore Ø mm	Stroke mm	Blows p/min ⁻¹	J/Blow	Air cons. l/s	Weight kg	Inlet-thread	Hose-diameter mm	Vibration m/s ²	Noise level dB(A)
RRH-2000	RRA	○ 11 x ○ 12,7 x 40	17,4	42	5.000	4,5	8,4	1,5	PT 1/4"	10	8	88